

Side Tables and End Tables

| <u>Item</u> | <u>Page #</u> |
|---|---------------|
| Item # 32HC Concord Side Table | 2 |
| Item # 171 Two Drawer Side Table | 2 |
| Item # 130 Side Table | 2 |
| Item # 251 Bermuda End Table | 3 |
| Item # 581 Plantation End Table | 3 |
| Item # 417 Tide Side Table | 3 |
| Item # 509 Seagrass Nightstand | 4 |
| Item # 520 Dockside Nightstand | 4 |
| Item # 535 Open Nightstand | 4 |
| Item # 135 Cottage Nightstand | 5 |
| Item # 540 Beaufort Side Table | 5 |
| Item # 122 Basket Weave Nightstand | 5 |
| Item # 528 Nightstand with Drawer | 6 |
| Item # 528F Fish Nightstand | 6 |
| Item # 532 Plantation Nightstand | 6 |
| Item # 514 Oglethorpe Nightstand | 6 |
| Item # 508 Sea Island End Table | 7 |
| Item # 510 Two Door Plantation Nightstand | 7 |



www.seabrookclassics.com

www.coastalwoodcraft.com

Phone: 843.466.0241 Fax: 843.466.0288

By **Coastal**  **Woodcraft**



Item # 32HC
Concord Side Table

- Round Top
- 1 Drawer in front
- Turned Legs
- 29H x 22 Round Top

PHOTO left

- Victorian over Seamist

Item # 171
Two Drawer Side Table

- Two Drawers
- Wood Knobs
- 29H x 22W x 22D @ Top

PHOTO right

- OPTIONAL Bail Handles
- Victorian White

See Options page



Item # 130
Side Table

- One Drawer
- Wood Knob
- 30H x 20W x 20D @ Top

PHOTO left

- Top: Tan
- Base: Seabrook Blue over Tan

See Options page



www.seabrookclassics.com

www.coastalwoodcraft.com

Phone: 843.466.0241 Fax: 843.466.0288

By Coastal Woodcraft



Item # 251
Bermuda End Table

- Tapered Legs
- Bermuda Shutter Panel Top
- 27H x 20W x 20D @ Top

PHOTO *left*

- Bayside

Item # 581
Plantation End Table

- Door Opens for Inside Storage
- 28.75H x 23W x 21D @ Top

PHOTO *right*

- Antique White over Frogmore Green



Item # 417
Tide Side Table

- Beadboard Top and Shelf
- 26H x 18W x 18D @ Top

PHOTO *left*

- Sun Porch



www.seabrookclassics.com

www.coastalwoodcraft.com

Phone: 843.466.0241 Fax: 843.466.0288

By Coastal  Woodcraft



Item # 509
Seagrass Nightstand

- One Drawer
- Bun Feet
- 24.5H x 22W x 17D
- Interior Depth: 14.5D

PHOTO left

- Square Seagrass Door
- Victorian White

All Door Styles available, see Options.

Item # 520
Dockside Nightstand

- Rope Trim
- Framed Flat Panel on Sides
- Two Drawers English Bead Trim
- One Open Shelf
- Old South Turned Feet
- 30H x 22.5W x 17.25D
- Drawers 6.75H, Open shelf 15D x 18.5W

PHOTO right

- Regatta over Natural, light rub
- See price list for option to customize with additional drawer, in place of open shelf.
Refer to Options Page*



Item # 535
Open Nightstand

- One Drawer
- Bun Feet
- 27H x 21W x 18D
- Interior Depth: 16.75D

PHOTO left

- Antique White over Brown

Refer to Options Page



www.seabrookclassics.com
www.coastalwoodcraft.com

Phone: 843.466.0241 Fax: 843.466.0288

By **Coastal Woodcraft**



Item # 135
Cottage Nightstand

- French Legs
- 3 Drawers
- 30.5H x 26W x 19D

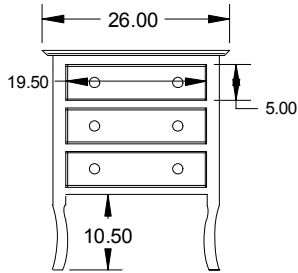

PHOTO left

- Weathered White

Item # 540
Beaufort Side Table

- Bracket Feet
- 3 Drawers
- 33H x 20W x 18D

PHOTO right

- Victorian White

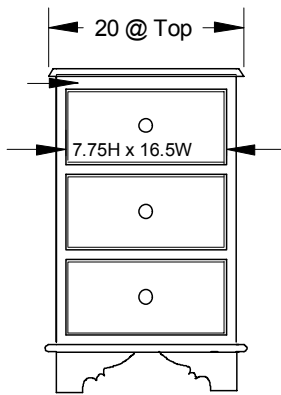

Item # 122
Basket Weave Nightstand

- Drawer
- Basket Weave on Fixed Shelf
- Tapered Legs and Small Tulip Feet
- 31H x 25W x 19.75D

PHOTO left

- Seabrook Black



www.seabrookclassics.com

www.coastalwoodcraft.com

Phone: 843.466.0241 Fax: 843.466.0288

By **Coastal Woodcraft**

Visit us at www.seabrookclassics.com



**Item # 528
Nightstand with Drawer**

- One Drawer
- One Door
- One Fixed Shelf
- Arched Base
- 30H x 15.5W x 13.75D

PHOTO left

- Plantation Shutter Door
- Flamingo

*All Door Styles available,
see Options*

**Item # 528F
Fish Nightstand**

PHOTO right

- Fish Cut-out Door
- Straight Base
- Seabrook Blue

*Same as Item # 528, but standard
with Straight Base, and Fish Door*



**Item # 532
Plantation Nightstand**

- One Door
- One Fixed Shelf
- 25.25H x 21W x 14.5D

PHOTO above

- Plantation Shutter Door
- Seabrook Blue

All Door Styles available, see Options



**Item # 514
Oglethorpe Nightstand**

- One Drawer
- Open Shelf
- Beadboard Backing
- 30H x 30W x 19D
- Oglethorpe Feet

PHOTO above

- Weathered White



www.seabrookclassics.com
www.coastalwoodcraft.com

Phone: 843.466.0241 Fax: 843.466.0288

By **Coastal Woodcraft**



Item # 508
Sea Island End Table

- One Drawer
- Two Doors
- Wood Knobs
- One Adjustable Shelf
- 32H x 26W x 18.5D @ Crown
- Inside Depth: 16D

PHOTO *right*

- Open Panel Doors (Open Panel Doors with Wooden Fabric Rods)
- Hibiscus over St Croix



PHOTO *Above left closed*

PHOTO *Lower Left open*

- Plantation Shutter Doors
- Oyster



*All Door Styles available,
see Options*

Item # 510

Two Door Plantation Nightstand

PHOTO *below*

- Two Doors
- Wood Knobs
- One Fixed Shelf
- 27H x 23.5W x 17D @ Crown
- Inside Depth: 15D
- Fish Cut-out Doors
- Bayside

All Door Styles available, see Options



PHOTO *below*

- Two Doors
- Wood Knobs
- One Fixed Shelf
- 27H x 23.5W x 17D @ Crown
- Inside Depth: 15D
- Palm Cut-out Doors
- Palm

All Door Styles available, see Options



SEABROOK  CLASSICS®
coastal living, cottage charm

www.seabrookclassics.com

www.coastalwoodcraft.com

Phone: 843.466.0241 Fax: 843.466.0288

By Coastal  Woodcraft

Visit us at www.seabrookclassics.com



by Coastal  Woodcraft

Orders or Inquiries
843.466.0241

Fax
843.466.0288

Email
Info@seabrookclassics.com



www.seabrookclassics.com
www.coastalwoodcraft.com

Phone: 843.466.0241 Fax: 843.466.0288

By Coastal  Woodcraft